

CRX-10iA



Max. load capacity
at wrist: 10 kg



Max. reach:
1249 mm

FANUC

Robot			Max. load capacity at wrist (kg)	Reach (mm)	Controlled axes	Repeatability (mm)	Mechanical weight (kg)	Motion range (°)						Maximum speed (°/s)						Allowable Wrist Load			Protection		
Series	Version	Type						J1	J2	J3	J4	J5	J6	J1	J2	J3	J4	J5	J6	J4 Moment/ Inertia	J5 Moment/ Inertia	J6 Moment/ Inertia	Input power source (VAC)	Body standard	Wrist & J3 arm
CRX	iA	10	10	1249	6	±0.04	39	380	360	570	380	360	380	120	120	180	180	180	180	34.8/ 1.28	26/ 0.9	11/ 0.3	100-120 200-240	IP67	IP67

● standard ○ on request - not available * max. cartesian speed 1000mm/sec ** Based on ISO9283 ***Option

CRX-10iA Standard model



CRX-10iA

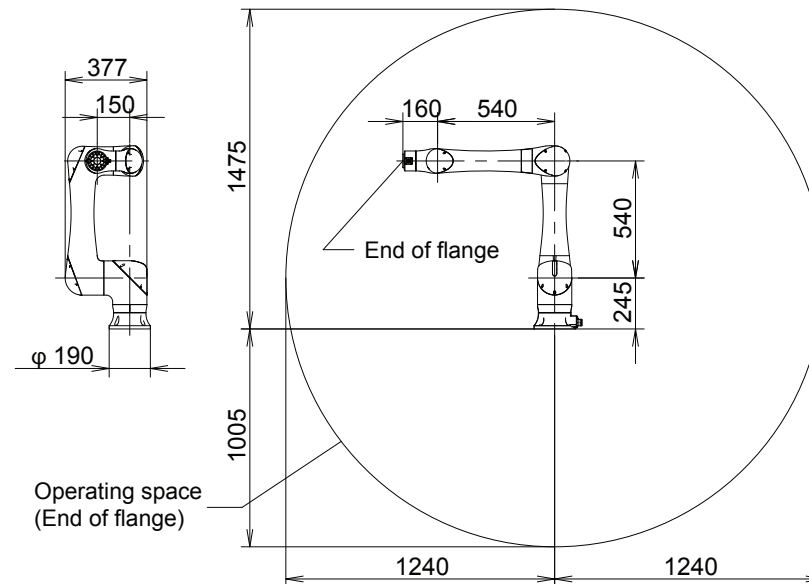
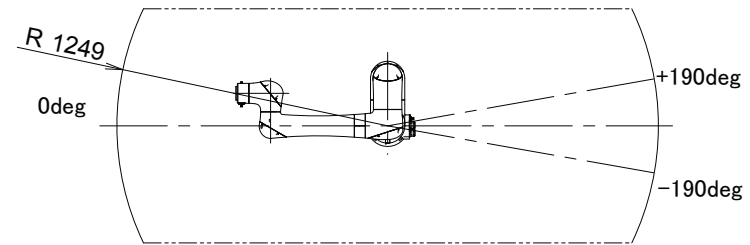

CRX-10iA/L



Max. load capacity
at wrist: 10 kg



Max. reach:
1418 mm

FANUC

Robot			Max. load capacity at wrist (kg)	Reach (mm)	Controlled axes	Repeatability (mm)	Mechanical weight (kg)	Motion range (°)						Maximum speed (°/s)						Allowable Wrist Load			Protection		
Series	Version	Type						J1	J2	J3	J4	J5	J6	J1	J2	J3	J4	J5	J6	J4 Moment/ Inertia	J5 Moment/ Inertia	J6 Moment/ Inertia	Input power source (VAC)	Body standard	Wrist & J3 arm
CRX	iA/L	10	10	1418	6	±0.04	39	360	360	540	380	360	380	120	120	180	180	180	180	34.8/ 1.28	26/ 0.9	11/ 0.3	100-120 200-240	IP67	IP67

● standard ○ on request - not available * max. cartesian speed 1000mm/sec ** Based on ISO9283 ***Option

CRX-10iA/L Long arm model



CRX-10iA/L

