

LR Mate/14-7D



Max. load capacity
at wrist: 14 kg



Max. reach:
717 mm

FANUC

Robot		Max. load capacity at wrist (kg)	Reach (mm)	Controlled axes	Repeatability (mm)	Mechanical weight (kg)	Motion range (°)						Maximum speed (°/s)**						Moments (N-m)/Inertia (kg-m ²)			Average Power consumption (kW)	Protection	
Series	Version						J1	J2	J3	J4	J5	J6	J1	J2	J3	J4	J5	J6	J4 Moment/ Inertia	J5 Moment/ Inertia	J6 Moment/ Inertia		Body standard/optional	Wrist & J3 arm standard/optional
LR Mate	D	14	717	6	± 0.01*	25	360 (340)	245	420	380	250	720	290	230	520	400	240	400	31/.66	31/.66	13.4/.30	0.5	IP67/ IP69K	IP67/ IP69K

(option) ● standard ○ on request - not available * Based on ISO 9283 ** During short distance motions, the axis speed may not reach the maximum value stated

LR Mate/14-7D Standard model (2 integrated solenoid valves)



LR Mate/14-7D

Operating space
of J5-axis rotation
center

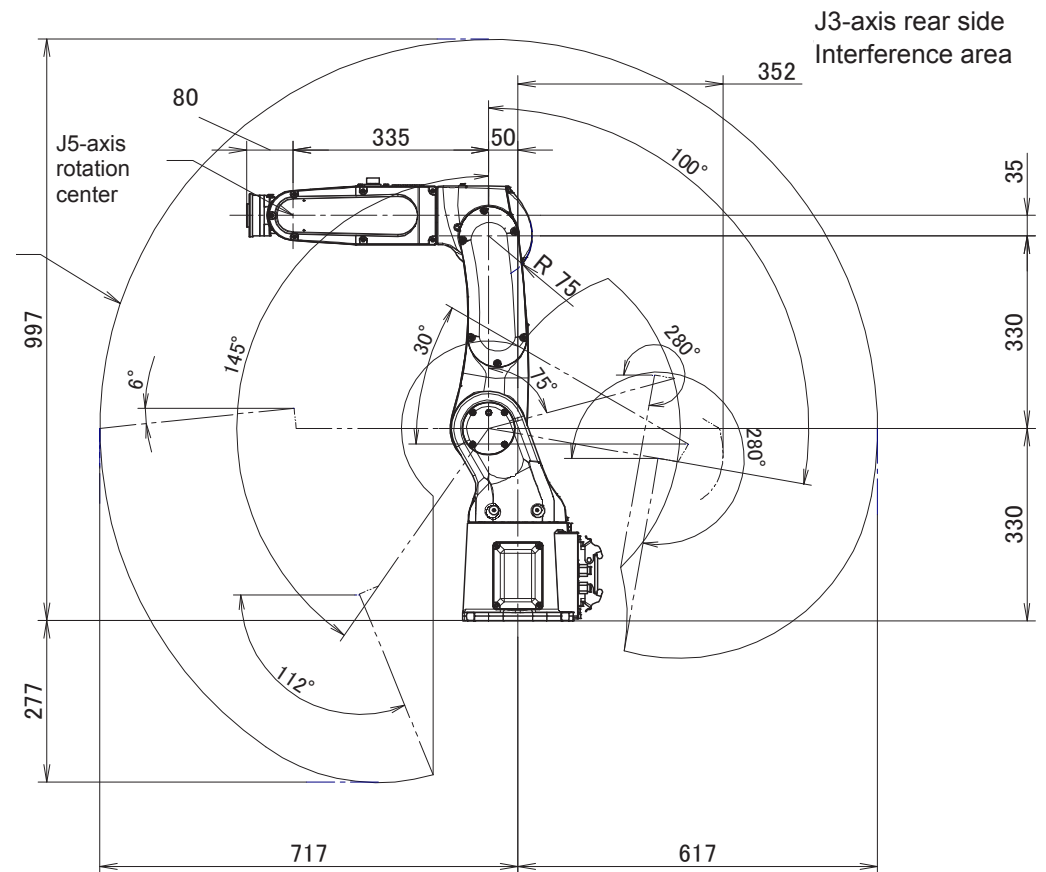

» If applied load on the robot exceeds 5kg when the robot is installed on an angle, the operating area is limited by the mount angle. If payload is less than 5kg, there is no restriction of the operating space.